

# Parish Council Newsletter October 2023

## Editorial

Another full events calendar which finds numerous villages and towns calling for singers for emerging choirs. One that unfortunately had to be left out was for a men's choir at Biggleswade, which following tuition for several weeks, resulted in a concert in aid of Cancer.

One of our Parish Council Members has had to retire with immediate effect, so the Council is appealing for a Parishioner to take their place.

After a successful Litterpick in September, the Litterpick Team will be covering Zones 4 & 5 (Sat 7<sup>th</sup> Oct), and 6 & 7 (Sat 21<sup>st</sup> Oct). If you wish to join them get in touch at [SMLitterpick@yahoo.com](mailto:SMLitterpick@yahoo.com) with your name and address.

You may have noticed that a seat at the bottom corner of the Recreation Ground has collapsed, anybody wishing to sponsor a replacement or donate one as a memorial for a loved one would be greatly appreciated.

Desma

## Events

### October

Sun Oct 1<sup>st</sup> – Fowlmere Airfield Open Day (p12)

Mon 2<sup>nd</sup> Oct – Trial Session Ashwell Choir (p9)

Sat 7<sup>th</sup> Oct – Litterpick – Zones 4 & 5 (p7)

Sat 7<sup>th</sup> Oct - Foxton Scarecrow Event (p10)

Sat 7<sup>th</sup> – 8<sup>th</sup> Oct – Ashwell Book Weekend (p9)

Sun 8<sup>th</sup> Oct – Harvest Lunch, Guilden Morden (p5)

Mon 11<sup>th</sup> Oct – Climate Change Course Applications (p10)

Sat 14<sup>th</sup> Oct – Social Event Quiz, Steeple Morden (p7)

Sat 21<sup>st</sup> Oct – Litterpick – Zones 6 & 7 (p7)

Sun 22<sup>nd</sup> Oct – Reimaging Community Energy, Cambridge (p2)

### November

Fri 11<sup>th</sup> & Sat 12<sup>th</sup> Nov – PALS, Play Steeple Morden (p 5)

Fri 17<sup>th</sup> Nov – Quiz Night, Steeple Morden (p12)

Fri – Sun 24 -26<sup>th</sup> Nov - Christmas Tree Festival (p7)

Sun 26<sup>th</sup> Nov – Bass Bell 10 Miler 2023 – Bassingbourn (p11)

### December

Sat 9<sup>th</sup> Dec – Hallelujah , Steeple Morden Church (p11)

## Editor

Desma Goddard Email: [newsletter@steeplemordenpc.org.uk](mailto:newsletter@steeplemordenpc.org.uk)

## Steeple Morden Parish Council List of Councillors as at September 2023

CLLR Jeremy CLAYTON (Chair)  
jeremy@steeplemordenpc.org.uk  
01763 853855

CLLR Keith AUSTIN  
kieth@steeplemordenpc.org.uk  
01763 852023

CLLR Nick BADGER (vice-chair)  
nick@steeplemordenpc.org.uk  
01763 852191

CLLR Malcolm BIRD  
malcolm@steeplemordenpc.org.uk  
01763 852469

CLLR Mark CARROLL  
mark@steeplemordenpc.org.uk  
07971 975146

CLLR Oliver PARSONS  
oliver@steeplemordenpc.org.uk

CLLR Sean TRAVERSE-HEALY  
sean@steeplemordenpc.org.uk  
01763 853843

CLLR Celia UPCHURCH  
celia@steeplemordenpc.org.uk  
01763 852193

DISTRICT CLLR MRS Heather WILLIAMS  
cllr.williamsh@scambs.gov.uk  
07885 774775

COUNTY CLLR MR Sebastian KINDERSLEY  
skindersley@hotmail.com  
01767 651982

**Parish Council Website:**  
[www.steeplemordenpc.org.uk](http://www.steeplemordenpc.org.uk)



➔ GO TO WEBSITE

Clerk to the PC: Sally Walmesley  
[clerk@steeplemordenpc.org.uk](mailto:clerk@steeplemordenpc.org.uk)



*“Join us for an exciting event - **Reimagining Community Energy Together!** On 22<sup>nd</sup> October. This in-person gathering is a fantastic opportunity to connect with like-minded individuals who share a passion for sustainable energy solutions.*

*With expert speakers and stalls from Octopus Energy’s community energy project, [Younity](#), Cambridgeshire County Council’s Head of Energy Services Eithne George, Transition Cambridge, Cambridge Carbon Footprint, and local people at various stages of actual community energy projects, including solar, wind and heat networks, we will explore how communities can work together to develop their own renewable community energy generation schemes.*

*Community Energy programmes often start with reducing energy needs in the first place, so we’ll also have local retrofitting experts on hand who can answer your questions about transitioning to comfortable, cost-effective homes that are good for us and the planet.*

*Expect engaging discussions, inspiring talks, and networking opportunities with experts in the field. Whether you're an energy enthusiast, a community leader, or simply curious about green initiatives, this event is for you! Register now at: <https://tinyurl.com/2b952fh2>”*



**Cambridge Carbon Footprint**  
The Bike Depot, 140 Cowley Road, Cambridge CB4  
0DL 01223 301842  
[www.cambridgecarbonfootprint.org](http://www.cambridgecarbonfootprint.org)

## NEWS FROM YOUR PARISH COUNCIL

The meeting is listed every month in the Village Garage Shop window, on the Notice Board at the Recreation Ground, and in near the station. A copy of the full minutes from the Council Meetings may be obtained by contacting the Parish Clerk, Sally Walmesley, Redwood Lodge, South Street, Litlington, Royston SG8 0QR. Telephone 01763 852137 or e-mail [clerk@steeplemordenpc.org.uk](mailto:clerk@steeplemordenpc.org.uk) Minutes can also be viewed on the Steeple Morden Village Website [www.steeplemordenpc.org.uk](http://www.steeplemordenpc.org.uk) and at the Village Garage Shop.

### Notes taken at the Parish Council Meeting held on Monday September 11<sup>th</sup>, at 7.00pm in the Cricket Pavilion.

A member of the Parish Council has decided retired with immediate effect; thus leaving the Council one short of the official number required to hold office. An appeal for an additional Parish Councillor will be made.

**County Councillor Sebastian Kindersley** - reported that a meeting will be held on October 6<sup>th</sup> at Bassingbourn to discuss the future of E/W rail link. The suggested congestion charges for Cambridge are all but dropped, with the resulting consequences that there will be no improvements in local transport. It will also impact on major building programmes such as Bourn which required local transport enhancements. Councillor Kindersley also warned that this could in turn affect the 5-year housebuilding supply and without an up-to date 'land supply plan' we could be in danger of land grabbing by builders. The issues regarding water have not been resolved, the reservoir which was planned seems very unlikely to proceed. Various roads in the area are scheduled to be surface dressed, Arrington/Wendy road, Wrestlingworth and Potton. The County Council are warning Parishioners about charging Lithium batteries inside the house, as there is a serious risk of fire from the use of non-compliant charging equipment.

**20mph zone application** - no feedback received even though decisions should have been made in July. Sebastian chasing up.

**District Councillor Heather Williams** - reported on the changes to the bin emptying times; everybody should have received information concerning the changes. Although the congestion charges have been dropped, it is possible that they could be brought back after the election.

**Four day working week** - is continuing for now but being strongly questioned from some quarters. The PC will be writing to various parties to express concern that elected representatives at council are not being given the opportunity to express views or influence the project.

**Broadband Link to Church** - a PCC meeting is to be held next week and this will cover the proposed link to move it forward. The PCC are looking for a contractor who can install an antenna on the peak of the nave. Once this is known a full submission will be need to be made to the church authorities to gain permission to touch the fabric.

**EV Chargers** - suffered a fault that was resolved within hours of the PC becoming aware. Now back in operation. Notices put up to ask that any issues be reported to the PC so they can be fixed. In addition, signs are to be put up at the entrance to the rec to show there are chargers available.

**Damage to Rec Ground Barrier** - has been repaired.

**Update on Play Area Repairs** - ongoing. A discussion was held whether to incorporate a basketball hoop near the play area. Another idea to be considered is the provision of a gym equipment trail around the recreation ground.

**Broken Bench** - the broken bench at the bottom of the recreation ground has been removed. Anyone wishing to sponsor a new bench or donate one as a memorial for a loved one would be greatly appreciated.

**Bowls Club Hedge** - it was decided to offer to cut the outside of the Bowls Club Hedge this year as a goodwill gesture following the Bowls club support of the EV Charging and Church broadband link projects.

**Car Park Resurfacing** - will go ahead in the Spring 2024 as a regrading of the gravel surface.

**Pavilion/Reading Room Decoration** - quotes will be in at the end of the month for external repair and refresh.

**CAPALC Conference** - 15<sup>th</sup> September - to be attended by Sally Walmesley

**CAPALC Review of Financial Regulations** - a survey to capture comments for a revision to the 2019 template to be undertaken by Sally Walmesley and Councillor Malcolm Bird.

**Date of the next council meeting will be October 9<sup>th</sup>.**

### **PLANNING APPLICATIONS**

#### **Planning 23/02736/LBC (for information)**

11 Cheyney Street - remove existing damaged roughcast render, make good and prepare the surface of the building, apply new lime based breathable insulated render to the building onto breathable wood fibre insulated render board fixed to the surface of the building and finish with lime wash.

#### **Planning Ref 23/02266/HFUL**

16 Hay Street - New window and filling in of existing door to side. RECOMMENDED

#### **Planning Ref 23/03197/HFUL**

41 Bogs Gap Lane - Demolition of the existing conservatory, single garage and shed and replace with a single storey side and link extension. (Information to be circulated and a meeting will be called if there are any queries)



**Guildden Morden Congregational Church**

is looking to set up a

## **Community Choir**

Songs to suit all tastes!

**We have a leader ready and waiting so why not come along and join in the fun whilst enhancing your wellbeing and making new friends!**

**If you would be interested in joining, then please contact Amanda Kitely at**

[ajgenieman@gmail.com](mailto:ajgenieman@gmail.com)

**LET  
YOUR  
HEART  
SING**



### **GROUP HARVEST SERVICE SUNDAY 8<sup>TH</sup> OCTOBER**

at St. Peter & St. Paul, Steeple Morden  
10am  
followed by  
**HARVEST LUNCH**  
St. Mary's Church, Guildden Morden  
at 12 noon

If you would like to come to lunch  
(£5 adult/£3 child)

please book on

[shingaychurches@gmail.com](mailto:shingaychurches@gmail.com)

or phone 01763 852380 (D & G  
McKee)

payment in cash or cheque (Shingay  
Group of Parishes) to 24 Cheyney  
Street

## **PARISH PANTRY**

**Local Food Bank**



Just a reminder that the Parish Pantry is in the porch of the church, should you have donations, or if you should be needing food.

If you are in a position to donate, items required are:

- Tinned Meat, Pies, Veg, Potatoes & Fruit
- Cereals
- UHT Milk
- Sugar
- Flour
- Pasta
- Pasta sauces
- Mug shots
- Pot noodles
- Individual wrapped cakes

Location:  
St Peter & St Paul Church  
Steeple Morden  
SG8 0NJ



For more info:  
Sam Carroll  
07494 588663  
[sdcarroll849@gmail.com](mailto:sdcarroll849@gmail.com)

**GIVE WHEN YOU CAN, TAKE WHEN YOU NEED**



## **PALS**

**Steeple Morden Players are proud to present a cast of all ages in PALS, an original one-act play on the theme of Memory and Remembrance.**

**November 10<sup>th</sup> & 11<sup>th</sup>  
Steeple Morden Village Hall**

**Saint Peter & Saint Paul Church  
Steeple Morden  
Dairy for October  
[www.shingaychurches.co.uk](http://www.shingaychurches.co.uk)**

**Sun Oct 1<sup>st</sup> – 8 30.am Holy Communion PB**

**Sun 8<sup>th</sup> Oct – 10.00am Group Harvest Service,  
Steeple Morden.  
(followed by Harvest Lunch at Guilden  
Morden)**

**Sun 15<sup>th</sup> Oct - 10.00am– Holy Communion,  
Steeple Morden with Wendy**

**Sun 22<sup>nd</sup> Oct - 10.00am - Group Parish  
Communion at Guilden Morden**

**Sun 29<sup>th</sup> Oct - 10.00am - Group Parish  
Communion at Guilden Morden**

**6.00pm – Service of  
Rememberance & Thanksgiving at Steeple  
Morden. (Tea & Coffee, and refreshments at  
5.00pm)**

**And Tuesdays in October  
Morning Prayer at Litlington Church, 10:00am**

Tues 5rd  
Tues 10th  
Tues 17th  
Tues 24th



followed by tea, coffee, and  
biscuits. Come, join and have a chat.

**Café Church  
Café Church will be open from 9am  
on the following Fridays –**

**6<sup>th</sup>, 13<sup>th</sup>, & 20<sup>th</sup> October**

**Everyone is welcome for  
tea, coffee, home-made cakes,  
toys for the children and chat**

**Guilden Morden Congregational Church  
Diary for October**

[www.guildenmordencongregationalchurch.org](http://www.guildenmordencongregationalchurch.org)

If you would like to have a chat with Tony, he will be in the Chapel every Monday morning between 9.30am and 11.30am. The “Sharing Table” in the front porch of the Chapel is still very much in use, so please place any spare foods that you have on the table so that others may make use of them. Packets and tins are especially welcome.

**Sunday 1<sup>st</sup> Oct** **10.30am** Café style service. Come and join us for croissants and coffee in our relaxed style of worship. All welcome.

**Monday 2<sup>nd</sup> Oct** **10.30am** Men’s Guild

**Tuesday 3<sup>rd</sup> Oct** **14.00pm** COGS

**Wed 4<sup>th</sup> Oct** **9.00 – 11.00am** Fun4Tots

**Sunday 8<sup>th</sup> Oct** **10.30am.** Joint service with Litlington at The Chapel

**Wed 11<sup>th</sup> Oct** **9.00 – 11.00am** Fun4Tots

**Sunday 15<sup>th</sup> Oct** **10.30am** Joint service with St Mary’s at The Chapel

**Wed 18<sup>th</sup> Oct** **9.00 – 11.00am** Fun4Tots

**Sunday 22<sup>nd</sup> Oct** **10.45am** Joint service at URC Ashwell

**Wed 25<sup>th</sup> Oct** **9.00 – 11.00am** Fun4Tots

**Sunday 29<sup>th</sup> Oct** **10.30am** Communion Service Joint with Litlington

**Other group meetings:**

Bridge Club Mondays at 19.30

Knit and Natter Alternate Tuesdays at 10.00am

GG Film Club Friday 20<sup>th</sup> Oct at 19.00pm

Local History Group Wednesday 4<sup>th</sup> Oct 15.00pm

Home group Zoom meetings Wednesdays 20.00pm ,  
Contact Emily for details [emilywilkinson@doctors.org.uk](mailto:emilywilkinson@doctors.org.uk)

Anyone wishing to book the rooms for social activities  
contact Gerry Watkins 01763 852869

**Sharing Table**

Did you know about our sharing table? This table has been running for quite a while now and has proved very successful. The slogan is: ‘Bring What You Can Take What You Need.’ We would be very grateful if you are able to donate food to the table. Equally if you need to use the table, please do so. You can enter with discretion by the side gate, so no one needs to know you’ve been there.



**Steeple Morden Parish Litter Picks Schedule 2023**  
**All events start at 2pm and last just 60 “magic” minutes**

|                |  |                           |
|----------------|--|---------------------------|
|                |  |                           |
| Zones 4 and 5: | Station Road from allotments to Ashwell Road to include Ashwell Road and Windmill Close etc<br>Station Road and Hay Street to Craft Way to include Craft Way<br>Meet by the Station Road and Ashwell Road intersection | Saturday 7 October 2023   |
| Zones 6 and 7: | Hay Street from Craft Way to Trap Road /North Brook End Trap Road/ Bogs Gap and Brook End<br>Meet by Parish Noticeboard on the rec   | Saturday 21 October 2023  |
| Zones 2-6      | Whole village sweep<br>Meet by Parish Noticeboard on the rec   | Saturday 11 November 2023 |
| Zone 1:        | Odsey<br>Meet by Zaheer’s carpark  | Saturday 25 November 2023 |

Please email [SMLitterpick@yahoo.com](mailto:SMLitterpick@yahoo.com) with your full name and which of the events you can attend.

**10<sup>TH</sup> CHRISTMAS TREE FESTIVAL**



Friday 24<sup>th</sup> to Sunday 26<sup>th</sup> November  
 St Peter & St Paul, Steeple Morden

Have you started planning your tree?  
 If so get together with friends, family, clubs or organisations.

We just bet you are ‘pining’ to show your talents

Help us to beat last year’s 30 trees and make this year  
**TREE-mendous.**

Registration forms and festival details can be obtained from Anne Hassall, 853490 – so what are you waiting for – give her a call now.

We’d love to hear from you if you have a little free time and would like to help over the weekend please contact Annie Bowen on 852905

**STEEPLE MORDEN BOWLS CLUB**

**SOCIAL EVENT**

**QUIZ**

**£5.00 PER PERSON**

***Teams – 8 or less***

**ON**

**SATURDAY 14<sup>th</sup> OCTOBER 2023**

**DOORS OPEN 7.00 pm**

**FOR 7.30 pm START**

**RAFFLE**

**BAR, TEA AND COFFEE**

**AVAILABLE**

**YOU ARE WELCOME TO BRING**

**YOUR OWN FOOD**

**Tickets can be obtained from  
 Bev Mack – 01763 230336 or a  
 committee member**

## Free Wi-Fi around Recreation Ground buildings

The Parish Council runs a free Wi-Fi service in and around the buildings on the Recreation Ground. The Cricket Pavilion, the Reading Room, the Village Hall and the Bowls Club are all covered.



The Wi-Fi in these areas is provided free of charge for public use by residents of Steeple Morden and for visitors to our village.

- To use the Wi-Fi simply select the network SSID: **SMPC\_Community**
- No password is required.
- Please use sensibly and responsibly.

If you have any problems send an email to: [webmaster@steeplemordenpc.org.uk](mailto:webmaster@steeplemordenpc.org.uk)



## Public EV Charge points operational on Recreation Ground

The Parish Council offers two EV Charge points on the Recreation Ground for public use by residents of Steeple Morden and for visitors to our village.



The pricing is currently 49p per kWh.

### Please use responsibly:

- Do not park in the charging bays unless charging
- Please treat equipment with care and respect
- Check charge status and remove car quickly when charging complete
- Do not drive off tarmac area and chew up grass

If you have any issues regarding the EV Chargers in the village please inform the Parish Council by sending an email to: [evchargers@steeplemordenpc.org.uk](mailto:evchargers@steeplemordenpc.org.uk)





**Are you interested in joining a local, relaxed and very friendly group of people who enjoy running, cycling, walking, talking and eating cake?**



Steeple Chasers Running & Cycling Club is now in its fourth year and we offer a range of activities such as trail runs, run fit sessions, mini cycling time trials, social cycles, Couch to 5k, fun runs and walks on a regular, seasonal basis.

We are a very social club of mixed abilities and goals, with our focus on encouragement, support and wellbeing. Based in Steeple Morden but open to anyone in the local area and villages.

**For more information check out our Facebook page to see a snapshot of our activities:**

<https://www.facebook.com/SteepleChasersRCC>

Or email our club secretary Sarah at:

[steeplechasersrcc@gmail.com](mailto:steeplechasersrcc@gmail.com)



**Annual membership**

- ⇒ **Just £25 for an individual**
- ⇒ **£20 per person for joint memb.**
- ⇒ **£15 if you are already a member of another club**

## ASHWELL BOOK WEEKEND

The 23<sup>rd</sup> Ashwell Book Weekend at St Mary's Church Ashwell.

Saturday 7<sup>th</sup> & Sunday 8<sup>th</sup> October  
 10am – 5pm – Saturday  
 1.30pm – 4.30pm – Sunday

Entrance £1.00  
 Children under 16 free.

A great selection of second hand book to browse and buy for children and adults, both fiction and non-fiction.

The, Coffee and home-made cakes available.

Money raised goes to St Mary's Restoration Fund



**FIRST TRIAL SESSION IS FREE!!**

Monday evenings from 8-9pm  
at the Ashwell Village Hall, SG7 5PJ

Ashwell's Big Sing is a warm and welcoming rock/pop community choir for adults of all abilities. No audition required, and you don't need to read music either.

- Light rock/pop/musical repertoire
- All resources provided with online tracks to help you learn
- Light-hearted fun
- Focus on friendship and community
- Regular concerts
- Support of local charities
- Improve your confidence and well-being
- £8 per session

For more information, please contact Liz Townsend at:  
[ashwellsbigsing@gmail.com](mailto:ashwellsbigsing@gmail.com) or 07753 754452



# Social Walking with Royston Health Walks



**Royston Health Walks** is an independent social walking group.

We have a number of different walks every Wednesday all of which start at The Heath Café, Baldock Road, Royston, SG8 5BG.

We have 2 walks at 10am, a leisurely walk over Therfield Heath covering about 1½ miles and a slow/flat walk. Both are opportunities to get a bit of exercise, have a chat and meet new people. The groups come together at the Café for a brew around 11am, please feel free to join us even if it's just for the brew.

**Our Wednesday afternoon walk is a bit more challenging and a little longer (about 2 miles). From May to September the start time is 5pm but changes to 2pm for the rest of the year. We end up at the Café for a brew.**

Anyone and everyone is welcome to join us regardless of age, level of fitness and in principle state of health, even if it's only for the refreshments.

*Welcoming,  
friendly, social  
and 'fun'*

*Positively  
inclusive and  
non-cliquey*

*"Ambling not  
rambling"*



*Children,  
buggies and  
dogs are all  
welcome*

*The walks  
are free,  
no booking  
required*

**Join us for a walk, a chat and a brew**

For more information call 01763 852769  
or email [roystonhealthwalks@btinternet.com](mailto:roystonhealthwalks@btinternet.com)

## Foxton Scarecrow Event

**Saturday October  
7<sup>th</sup>**

**12noon – 5pm**



## ST PETER & ST PAUL CHURCH STEEPLE MORDEN

**SATURDAY DECEMBER 9<sup>TH</sup> AT 7.00PM**

**'HALLELUJAH'  
CHRISTMAS THROUGH THE AGES FOR CHOIR,  
ORGAN AND AUDIENCE  
PERFORMED BY**

**THE NEW CAMBRIDGE SINGERS  
LICENSED BAR, INTERVAL CANAPES,  
RETIRING COLLECTION  
FOR UNHCR DISASTERS & EMERGENCY  
APPEAL**

*Tickets adults £14 students/under 18 £6.00 will be  
available from Steeple Morden Shop  
or on the door. For more information contact D  
McKee 01763 852380*

*Organised by The Friends of S S Peter & Paul charity  
no: 292004*





## *brainstrust* Bass Belle 10 Miler 2023

Date & Time: Sunday 26<sup>th</sup> November 10.00 – 12.30pm

Location: Bassingbourn Village College, South End. Bassingbourn.

**FIGHT FOOD WASTE**

Take the food pledge and receive tips on how to reduce your food waste

[www.recap.co.uk](http://www.recap.co.uk) Cambridgeshire and Peterborough recycles



### **Royston Choir**

**Royston Town Hall  
Melbourn Street  
Royston**

**Monday Evenings  
7.30pm – 9.00pm**

**...from September  
[www.somewhere2sing.co.uk](http://www.somewhere2sing.co.uk)**



## Quiz Night

Friday 17<sup>th</sup> November 2023  
at  
Steeple Morden Village Hall  
Arrival at 7.00 p.m. for 7:30 p.m. start

£15 to include supper  
(maximum of 8 to a team)

Licensed Bar

Tickets available from

Kate Alsop – 01462 743561 / Fiona Coverdale – 07962215982  
Peter Garner – 853133 / Avril Gilbert – 853173 / Debbie Hall – 853982  
Doug Johnston – 853890 / Debbie Louch – 853271 / Debbie Shepherd – 852742

All proceeds in aid of Steeple Morden Tennis Club



St Mary's Ashwell

23<sup>rd</sup> Ashwell Book Weekend  
7<sup>th</sup> October 10.00am  
8<sup>th</sup> October 4.40pm

Please bring all your spare books to the Church on Monday 2<sup>nd</sup> October to Thursday 5<sup>th</sup> October from 10.00pm to 5.00pm. Please no dictionaries, encyclopaedias, videos, cassettes or magazines (they do not sell)

## FOWLMERE AIRFIELD MUSEUM



**Next  
open day  
Oct 1st  
10 till 4**

**Manor farm SG87SH**





## Supporting people to live independently

We have been a registered charity since 2006, covering the Parish Council areas of Guilden Morden, Steeple Morden and Litlington. We extended our Scheme to include Bassingbourn cum Kneesworth in 2016. Our committee of Trustees are appointed by these four Parish Councils.

We employ a part-time Warden to provide the service – making sure that people feel safe and secure in their own homes; keeping a watchful eye out for their health and welfare; liaising with local medical and social support services to ensure their needs are met.

Our Warden has experience of caring for frail or infirm elderly people and is selected for their ability to interact and build a trusting relationship with each member.

We ensure that the Warden has the necessary training to carry out his or her duties.

**Contact No: 07841 025107**  
**mobilewardenscheme@gmail.com**

## Yasmeen Farooqui

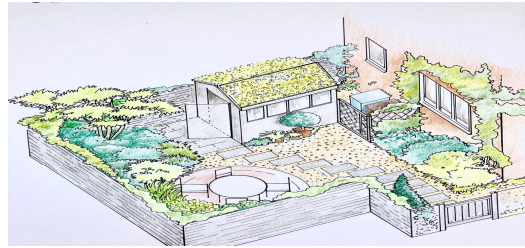

Hello, I usually write the gardening column in Prospect magazine under my married name of Brigstocke. I'm going to be teaching the Sustainable Garden Design course at Comberton Village College, on Wednesday evenings starting next week. (September 20<sup>th</sup>) We'll be looking at how to design your garden so that it is good for wildlife, is environmentally friendly and doesn't use materials which will add to climate change issues. It's about how to garden in a changing climate and we be looking at suitable plants to use to adapt to these the variable weather. If you are interested please contact the adult education department at Comberton village college

**Email: [commed@catrust.co.uk](mailto:commed@catrust.co.uk)**  
**Tel: 01223 264721.**

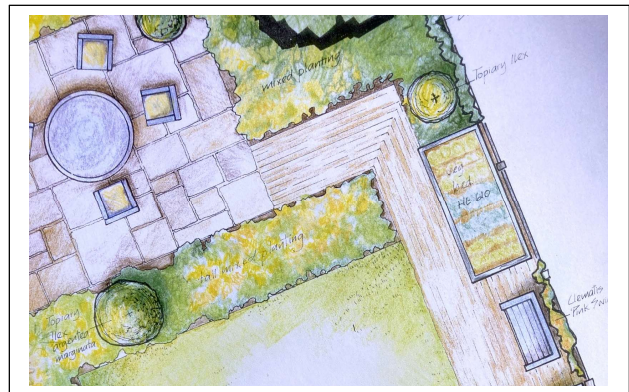

We would like to thank everyone who has supported the Morden's branch of Save the Children over many years. In that time, we have raised over £105,000 for a charity that works throughout the world to save, feed, provide health support, educate and generally improve the lives of vulnerable children.

It is with much sadness that several members of the committee are no longer able to continue.

Consequently, the branch is no longer viable. However, there will be occasional events with all the proceeds donated to Save the Children at which your continued support will be much appreciated.

Should anyone feel in a position to re-establish the committee, please contact or text 07764 677 100.

With much gratitude, *Iverna, Robert, Jill, Sue, Margaret, Marion, Debbie, Pam.*

## **Steeple Morden Cricket Club CCA Junior 3 West**

After a very successful 2022 year SM Cricket Club are now in CCA Junior 3 West League.

### **Fixtures for 2023**

|                               |   |                        |
|-------------------------------|---|------------------------|
| <b>1<sup>st</sup> July</b>    | <b>Steeple Morden 1<sup>st</sup> XI v Longstowe</b>               | <b>Won by 67 runs</b>  |
| <b>8<sup>th</sup> July</b>    | <b>Milton v Steeple Morden 1<sup>st</sup> XI</b>                  | <b>Lost by 116</b>     |
| <b>22 July</b>                | <b>Cottenham 11 v Steeple Morden 1<sup>st</sup> XI</b>            | <b>Cancelled</b>       |
| <b>29<sup>th</sup> July</b>   | <b>Steeple Morden 1<sup>st</sup> XI v Harlton</b>                 | <b>Lost by 72 runs</b> |
| <b>5<sup>th</sup> August</b>  | <b>Madingley v Steeple Morden 1<sup>st</sup> XI</b>               | <b>Cancelled</b>       |
| <b>19<sup>th</sup> August</b> | <b>Steeple Morden 1<sup>st</sup> XI v Cam Kerala</b>              | <b>Lost by 25 runs</b> |
| <b>26<sup>th</sup> August</b> | <b>Stapleford v Steeple Morden 1<sup>st</sup> XI</b>              | <b>Won by 64 runs</b>  |
| <b>2<sup>nd</sup> Sept</b>    | <b>Cam Kerala v Steeple Morden 1<sup>st</sup> XI</b>              | <b>Lost by 28 runs</b> |
| <b>10<sup>th</sup> Sept</b>   | <b>Steeple Morden 1<sup>st</sup> XI v Guilden Morden (1.30pm)</b> | <b>Cancelled</b>       |

**All matches start at 1.00pm**

## **Steeple Morden Football Fixture List for 2023/4**

### **Steeple Morden 1<sup>st</sup> – Fixture Group 2A**

#### **Steeple Morden Veterans – Fixture Group Vets Division 2**

|                 |   |                   |
|-----------------|---|-------------------|
| <b>2/9/23</b>   | <b>Comberton United Reserves vs SM 1<sup>st</sup></b>             | <b>Drew 1 - 1</b> |
| <b>9/9/23</b>   | <b>SM 1<sup>st</sup> vs Guilden Morden 1<sup>st</sup></b>         | <b>Lost 0 - 1</b> |
| <b>10/9/23</b>  | <b>Bluntisham Rangers Vets vs SM Vets</b>                         | <b>Won 2 - 4</b>  |
| <b>16/9/23</b>  | <b>Ashdon United Saturday 1<sup>st</sup> vs SM 1<sup>st</sup></b> | <b>Lost 3 - 2</b> |
| <b>17/9/23</b>  | <b>SM Vets vs Kedington FC Vets</b>                               | <b>Won 5 - 1</b>  |
| <b>23/9/23</b>  | <b>SM 1<sup>st</sup> vs Balsham 1<sup>st</sup> Team</b>           |                   |
| <b>30/9/23</b>  | <b>Cambourne Town Men vs SM 1<sup>st</sup></b>                    |                   |
| <b>1/10/23</b>  | <b>Cambridge Ambassadors Vets vs SM Vets</b>                      |                   |
| <b>07/10/23</b> | <b>SM 1<sup>st</sup> vs Clare Town FC Reserves</b>                |                   |
| <b>14/10/23</b> | <b>SM 1<sup>st</sup> vs Ashdon United Saturday 1<sup>st</sup></b> |                   |
| <b>15/10/23</b> | <b>Moulton Veterans FC Vets vs SM Vets</b>                        |                   |
| <b>21/10/23</b> | <b>SM1st vs Cambridge Ambassadors First</b>                       |                   |
| <b>28/10/23</b> | <b>Cambridge Ambassadors First vs SM1st</b>                       |                   |

**First Team games start at 15.00pm**

**Veterans games start at 10.30am**



## Contact Names, Numbers and E-Mail Addresses for Organisations and Groups in the Village



| Organisation                               | Contact                            | Phone No                    | E-mail   |
|--|------------------------------------|-----------------------------|--|
| SM Newsletter Editor                       | Desma Goddard                      | 01763 852287                | <a href="mailto:newsletter@steplemordenpc.org.uk">newsletter@steplemordenpc.org.uk</a>   |
| First Responders                           | Nick Badger                        | 01762 852191                | <a href="mailto:nickmbadger@yahoo.co.uk">nickmbadger@yahoo.co.uk</a>   |
| First Responders (co-ordinator)            | Wayne Cox                          |                             | <a href="mailto:waynecox79@yahoo.co.uk">waynecox79@yahoo.co.uk</a>   |
| Primary School                             | Tracey How, Head Teacher           | 01763 852474                | <a href="mailto:office@steplemorden.cambs.sch.uk">office@steplemorden.cambs.sch.uk</a>   |
| Village College                            | The Principal<br>Ms Vickey Poulter | 01763 242344                | <a href="mailto:office@bassingbournvc.net">office@bassingbournvc.net</a>   |
| SS Peter & Paul Church                     | Associate. Priest<br>Revd Ann Bol  | 01223 871058                | <a href="mailto:RevAnn801@gmail.com">RevAnn801@gmail.com</a>   |
| GM Cong. Church                            | Sandy Watkins                      | 01763 852869                | <a href="mailto:sandy@inteserv.co.uk">sandy@inteserv.co.uk</a>   |
| SM Village Hall Bookings                   | Diane Knight                       | 01763 853073                | <a href="mailto:viguersk@aol.com">viguersk@aol.com</a>   |
| Scouts, Cubs & Beavers                     | Keith Austin                       | 01763 852023                | <a href="mailto:keith@bogsgap.co.uk">keith@bogsgap.co.uk</a>   |
| Brownies                                   | Sarah Douglas                      |                             | <a href="mailto:cmtdouglasphoto@gmail.com">cmtdouglasphoto@gmail.com</a>   |
| Guides                                     | Liz Haigh                          |                             | <a href="mailto:steplemordenguides@gmail.com">steplemordenguides@gmail.com</a>   |
| Allotment Society                          | Nettie Traverse-Healey             | 01763 853843                | <a href="mailto:nettieth@outlook.com">nettieth@outlook.com</a>   |
| Smarties Pre-School and Out of School Club |                                    | 01763 852888                | <a href="mailto:smartiesmanager1@gmail.com">smartiesmanager1@gmail.com</a><br><a href="mailto:smrtiesoosclub@gmail.com">smrtiesoosclub@gmail.com</a> |
| Cricket Club                               | Fraser Daws                        | 01763 853008                | <a href="mailto:fraser.daws@btinternet.com">fraser.daws@btinternet.com</a>   |
| Football Club                              | Pete Summers                       | 07709258359                 |  |
| Morden Magpies Youth FC                    | Shelley<br>Bainborough             | 07778181334                 | <a href="mailto:dudshell@hotmail.com">dudshell@hotmail.com</a>   |
| Bowls Club (Sec)                           | Anthony Johnson                    | 07423 436283                | <a href="mailto:williamsj300@outlook.com">williamsj300@outlook.com</a>   |
| Tennis Club                                | Fiona Coverdale                    | 01763 853325                | <a href="mailto:steplemordentennis@yahoo.co.uk">steplemordentennis@yahoo.co.uk</a>   |
| Steeple Chasers Running & Cycling Club     | Sarah Anderson                     |                             | <a href="mailto:steplechasersrcc@gmail.com">steplechasersrcc@gmail.com</a>   |
| Morden Players                             | Jenny Elder                        | 01763 852557                | <a href="mailto:jennyelder@sky.com">jennyelder@sky.com</a>   |
| First Thursday Club                        | Ann Thorp                          | 01763 852848                | <a href="mailto:annthorp35@icloud.com">annthorp35@icloud.com</a>   |
| Royal British Legion                       | Patricia Covington                 | 01763 852982                | <a href="mailto:alb@mypostoffice.co.uk">alb@mypostoffice.co.uk</a>   |
| Mobile Wardens Scheme                      | Geoff Harper<br>Claire Barnett     | 01763 853845<br>07841025107 | <a href="mailto:mobilewardenscheme@gmail.com">mobilewardenscheme@gmail.com</a>   |
| WI   | Joyce Stackhouse                   | 01763 852087                | <a href="mailto:joyce.stackhouse@icloud.com">joyce.stackhouse@icloud.com</a>   |
| Neighbourhood Watch                        |                                    |                             | Cambs Police: <a href="http://www.cambs.police.uk">www.cambs.police.uk</a>   |
| Social Car Scheme                          | Hazel Smith                        | 01763 852602                | <a href="mailto:hcsmith@clara.co.uk">hcsmith@clara.co.uk</a>   |
| Ashwell & Bassingbourn Patient Group       | Rachel Capay                       | 01763 853446                |  |

# STEEPLE MORDEN VILLAGE HALL



Steeple Morden Village Hall is available for hiring for Parties, Wedding receptions, club and social activities

*It comprises: Tables, Seating for 120, Bar, Kitchen, Cooker, Fridge, Stage, Parking. There is also limited Crockery & Cutlery  
Projector and screen available and Induction Loop Equipment – ask our booking clerk for more details.*

For bookings and prices please contact:

**Diane Knight**

**33 Cheyney Street, Steeple Morden, SG8 0LR**

**Tel 01763 853073** (please don't phone between the hours of 6 - 7 p.m.)

email: [viguersk@aol.com](mailto:viguersk@aol.com)

[www.steeplemordenvillagehall.co.uk](http://www.steeplemordenvillagehall.co.uk)

## Mobile Library

Stops in VILLAGE HALL between 10.15-11.00am.  
The next calling date is Tuesday October 3rd 2023



## The Village Wheelchair

There is a manual wheelchair available for short term use by anyone in the village. For more information and availability please contact Trish at the Garage Shop

Don't forget you can view this issue and back issues of the Newsletter online; you can also subscribe to receive notification of when the newsletter is available on

[www.steeplemordenpc.org.uk](http://www.steeplemordenpc.org.uk)

Contributions sent to the editor prior to the newsletter deadline will be printed in the next available edition.

The deadline for November edition is 12 noon on October 17<sup>th</sup> 2023

Contact details for the editor are at the bottom of the first page of the Newsletter

**DESIGN. PRINT. FINISH.**  
the **PRINTWORKS**



01763 852579  
[sales@print-works.com](mailto:sales@print-works.com)

  @makingprintworkforyou